

PAWEL PRZYBYSZEWSKI

Master of Science in Civil Engineering.
Chartered Civil and Structural Engineer.
Licenced Construction Manager.

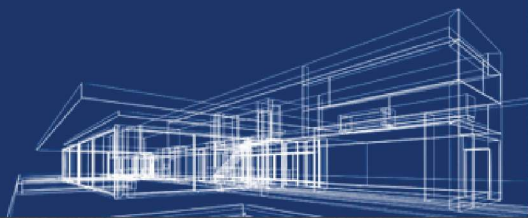

POLAND 2000 - 2001

Dom Development S.A. Warsaw.

Project Manager.

Turn-key projects: Estate of 12 buildings, total 560 flats, budget €28.0M.

Two levels underground parking, 8 floors of superstructure, roads and utilities.

Housing estate of single family houses, budget € 4.0M.

